

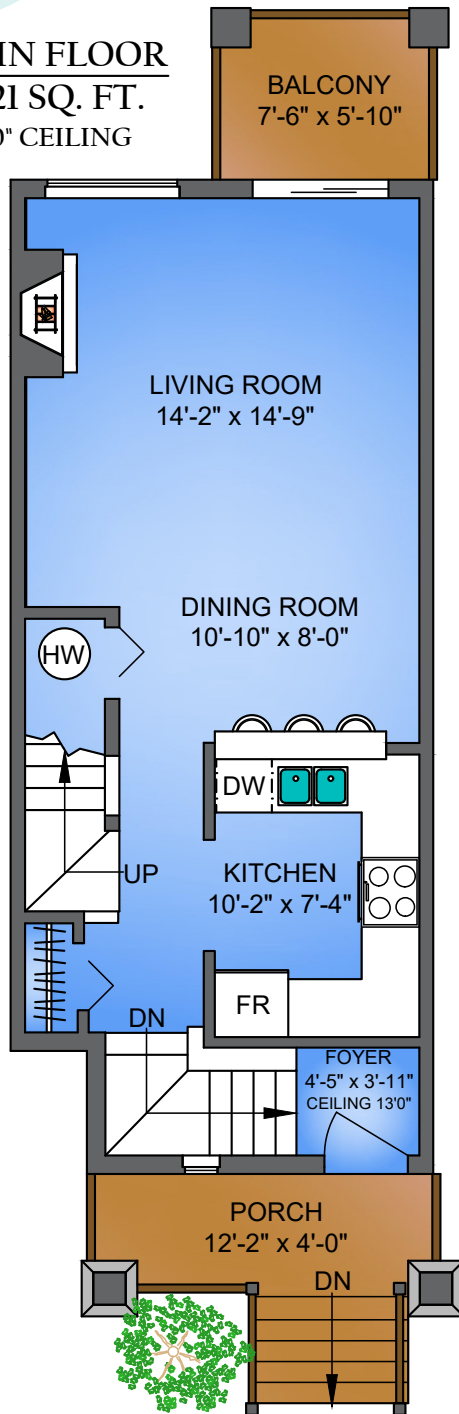

45-123 SEVENTH STREET NEW WESTMINSTER, BC

MAIN FLOOR
521 SQ. FT.
8'0" CEILING



UPPER FLOOR
521 SQ. FT.
8'0" CEILING

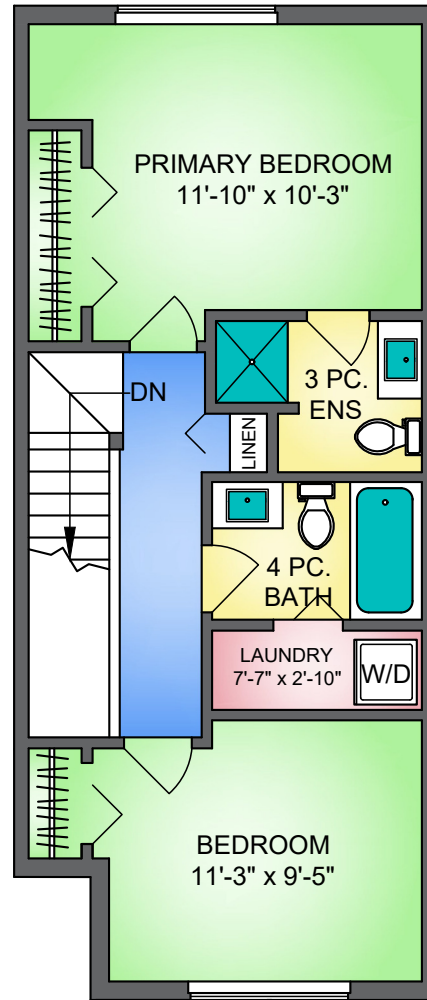

NORTH

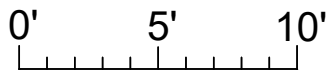

SCALE

45-123 SEVENTH STREET, NEW WESTMINSTER		
NOVEMBER 12, 2024		
PREPARED BY PROPER MEASURE.		
FOR THE EXCLUSIVE USE OF LORI FRALIC.		
<small>PLANS MAY NOT BE 100% ACCURATE, IF CRITICAL BUYER TO VERIFY E&O INSURED.</small>		
FLOOR	AREA (SQ. FT.)	
	FINISHED	DECK / PATIO
MAIN	521	90
UPPER	521	-
TOTAL	1042	90