

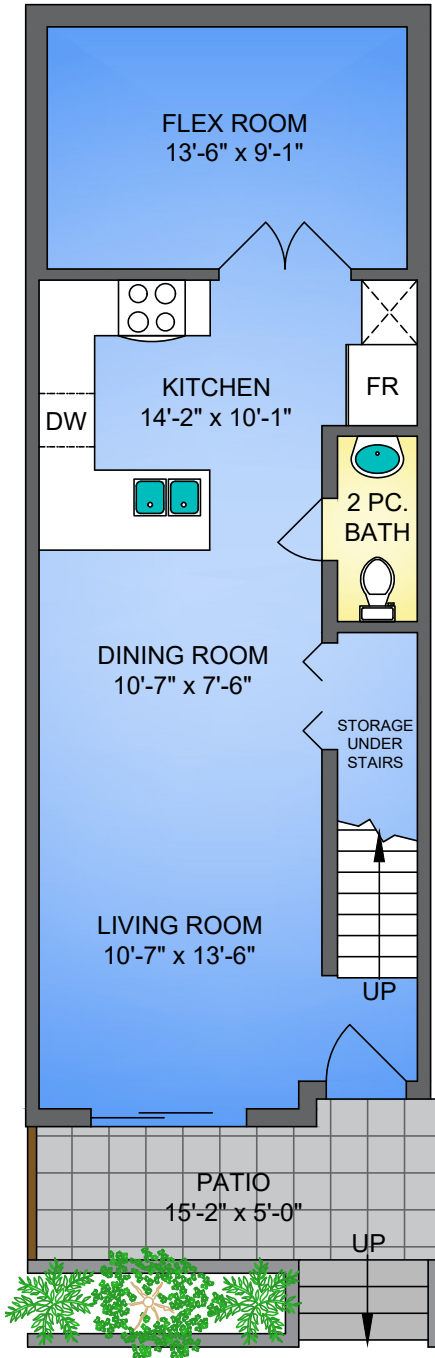

111-828 ROYAL AVENUE NEW WESTMINSTER, BC

MAIN FLOOR

629 SQ. FT.
9'1"-7'11" CEILING



UPPER FLOOR

466 SQ. FT.
7'10" CEILING

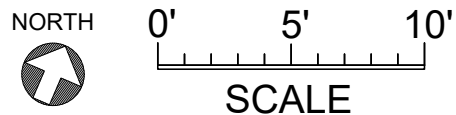
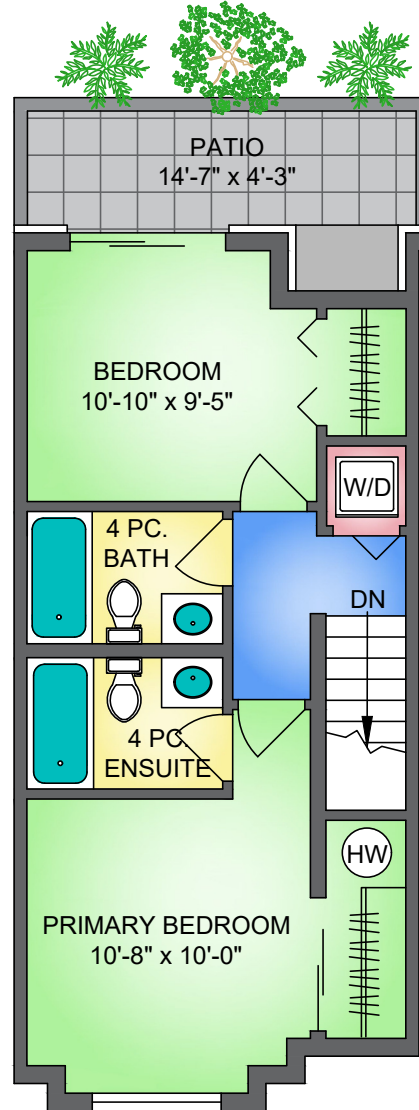

111-828 ROYAL AVE, NEW WESTMINSTER
OCTOBER 21, 2022
PREPARED BY PROPER MEASURE.
FOR THE EXCLUSIVE USE OF LORI FRALIC AND LESLIE GRAY.
PLANS MAY NOT BE 100% ACCURATE. IT IS RECOMMENDED THAT BUYERS VERIFY DIMENSIONS AND MEASUREMENTS ARE APPROXIMATE.

FLOOR	AREA (SQ. FT.)	
	FINISHED	DECK / PATIO
MAIN	629	81
UPPER	466	74
TOTAL	1095	155



Lori Fralic PREC
604-312-0738

Leslie Gray PREC
604-833-7780

fralicrealestate.com

KW VANCENTRAL
KELLER WILLIAMS REALTY
EACH OFFICE IS INDEPENDENTLY OWNED AND OPERATED