

# 411 THIRD STREET NEW WESTMINSTER, BC

MAIN FLOOR	762	SQ FT
BELOW MAIN FLOOR	555	SQ FT
<b>TOTAL FINISHED AREA</b>	<b>1,317</b>	<b>SQ FT</b>

GARAGE*	216	SQ FT
PATIO*	83	SQ FT
BACK YARD*/**	538	SQ FT

\*NOT INCLUDED IN OVERALL SQUARE FOOTAGE  
\*\*BACK YARD AREA INCLUDES PATIO

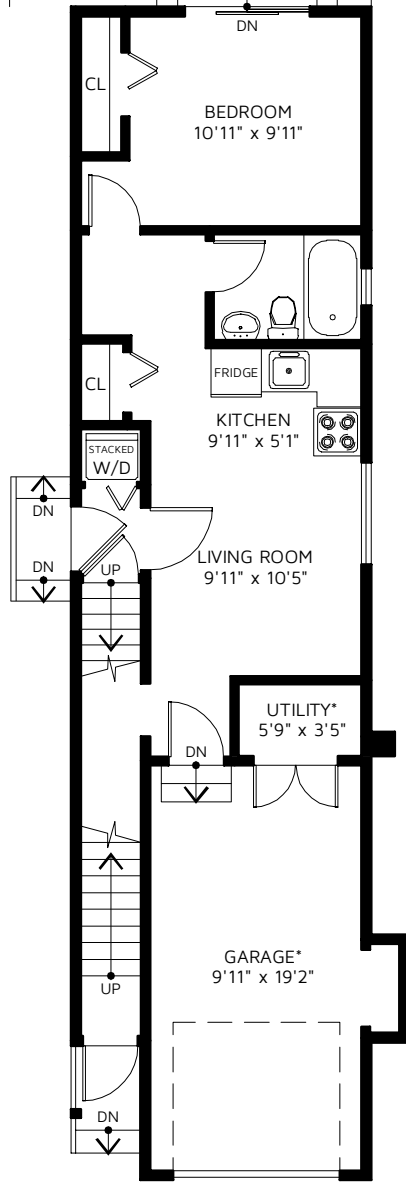
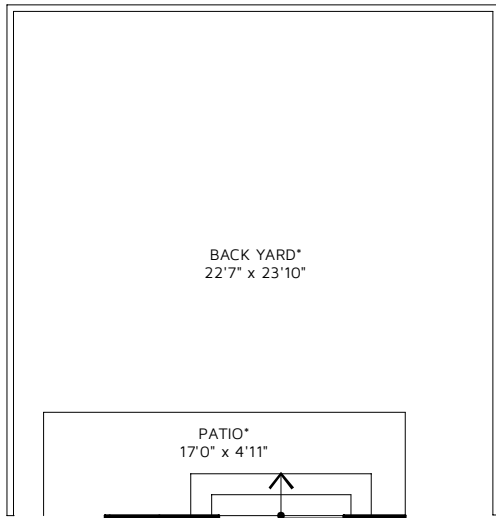

BELOW MAIN FLOOR

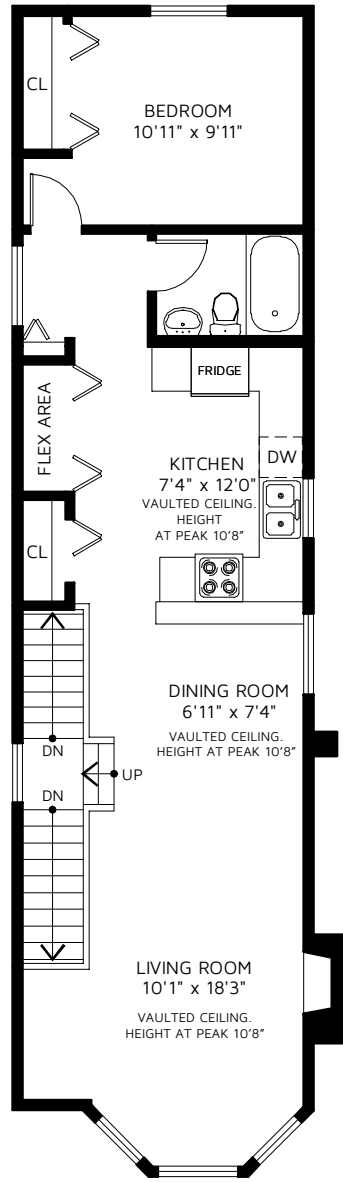

MAIN FLOOR



**LORI FRALIC**  
REALTOR®

FLOOR PLAN IS PROVIDED BY REAL MEASUREMENTS AND RENDERINGS. FOR PROMOTIONAL USE ONLY. NOT FOR ARCHITECTURAL OR CONSTRUCTION USE. AREA IS CALCULATED USING ANSI Z765 - 2003 METHOD. WHILE EVERY EFFORT IS MADE TO ENSURE THE ACCURACY, DIMENSIONS AND TOTAL AREA ARE NOT GUARANTEED. TOTAL AREA MAY INCLUDE UNFINISHED OR UNDER HEIGHT AREA. E&OE

