

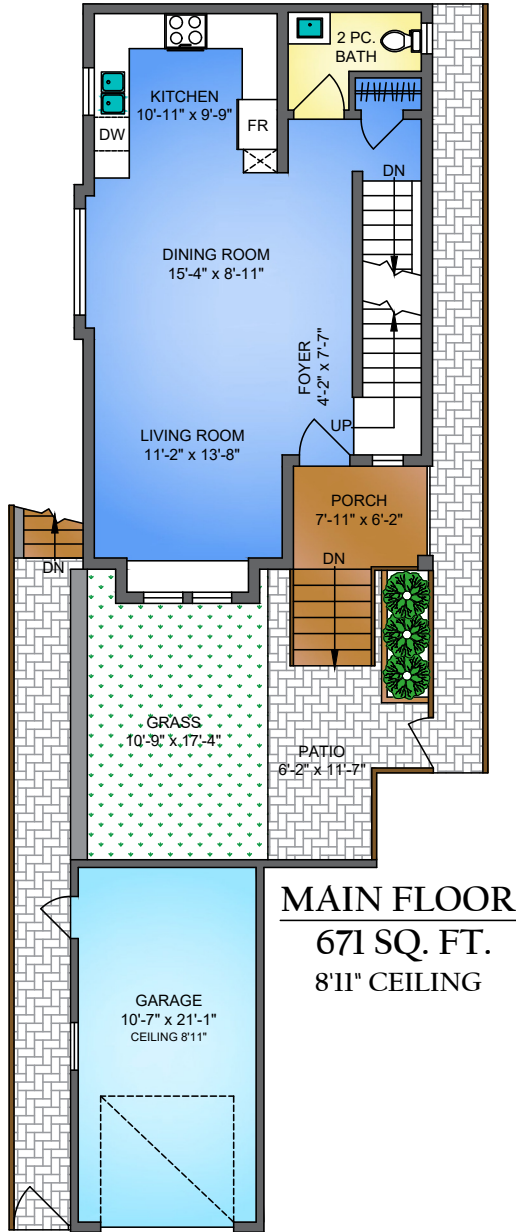

# 2-1014 FOURTH AVENUE NEW WESTMINSTER, BC



**MAIN FLOOR**  
671 SQ. FT.  
8'11" CEILING

**UPPER FLOOR**  
702 SQ. FT.  
8'0" CEILING

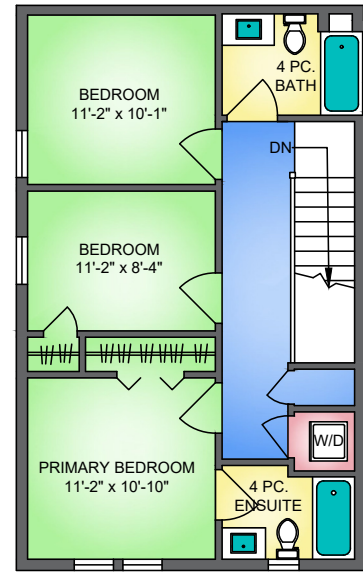

**LOWER FLOOR**  
684 SQ. FT.  
8'0" CEILING

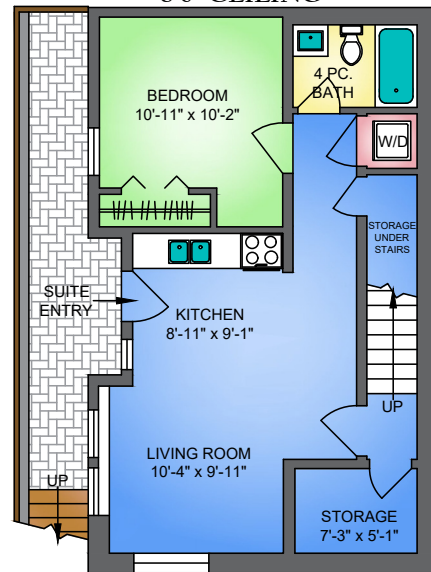

NORTH

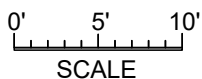

2-1014 4TH AVE, NEW WESTMINSTER OCTOBER 21, 2022 PREPARED BY PROPER MEASURE. FOR THE EXCLUSIVE USE OF LORI FRALIC AND LESLIE GRAY. <small>PLANS MAY NOT BE 100% ACCURATE, IF CRITICAL BUYER TO VERIFY DIMENSIONS AND MEASUREMENTS ARE APPROXIMATE.</small>			
FLOOR	AREA (SQ. FT.)		
	FINISHED	GARAGE	DECK / PATIO
MAIN	671	255	123
UPPER	702	-	-
LOWER	684	-	-
<b>TOTAL</b>	<b>2057</b>	<b>255</b>	<b>123</b>