

221 MANITOBA STREET NEW WESTMINSTER, BC

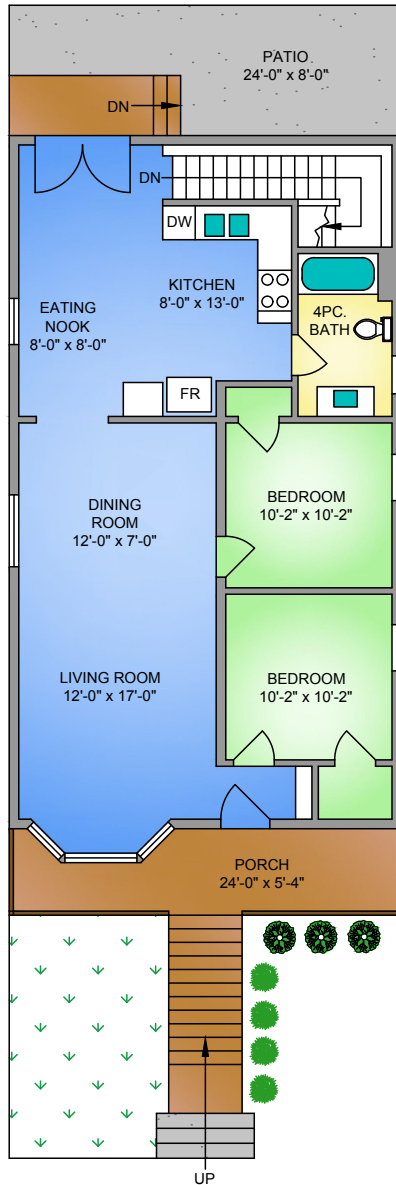

MAIN FLOOR
1040 SQ. FT.
9'-0" CEILING HEIGHT

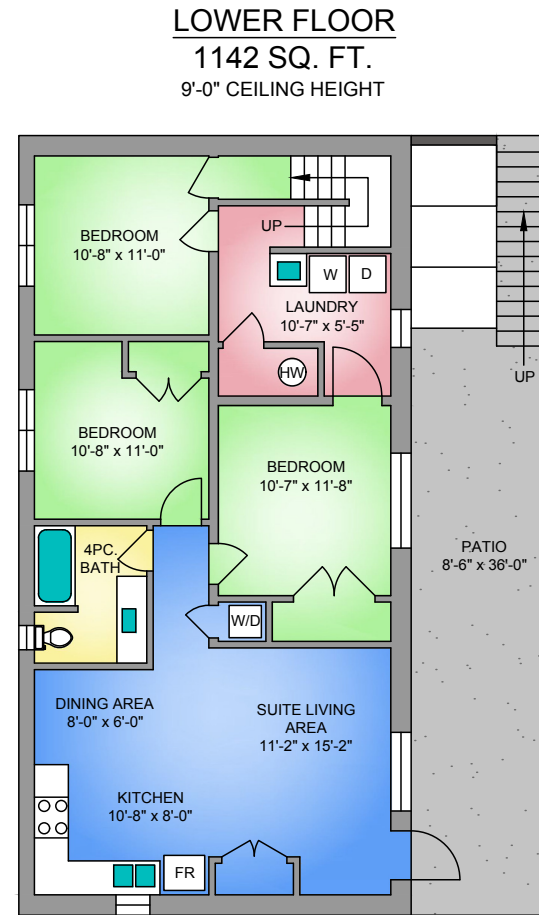

LOWER FLOOR
1142 SQ. FT.
9'-0" CEILING HEIGHT

NORTH



221 MANITOBA STREET, NEW WESTMINSTER
AUGUST 23, 2021
PREPARED FOR THE EXCLUSIVE USE OF LESLIE GRAY.
PLANS MAY NOT BE 100% ACCURATE, IF CRITICAL BUYER TO VERIFY.

FLOOR	TOTAL	AREA (SQ. FT.)	
		FINISHED	DECK / PATIO
MAIN	1040	1040	300
LOWER	346	346	-
SUITE	806	806	310
TOTAL	2192	2192	610