



#201-15 E ROYAL AVENUE
NEW WESTMINSTER, BC

Main Floor: 1,148 sq.ft.

Ceiling Height: 8'-8"

Auxiliary Area

Patio: 484 sq.ft.

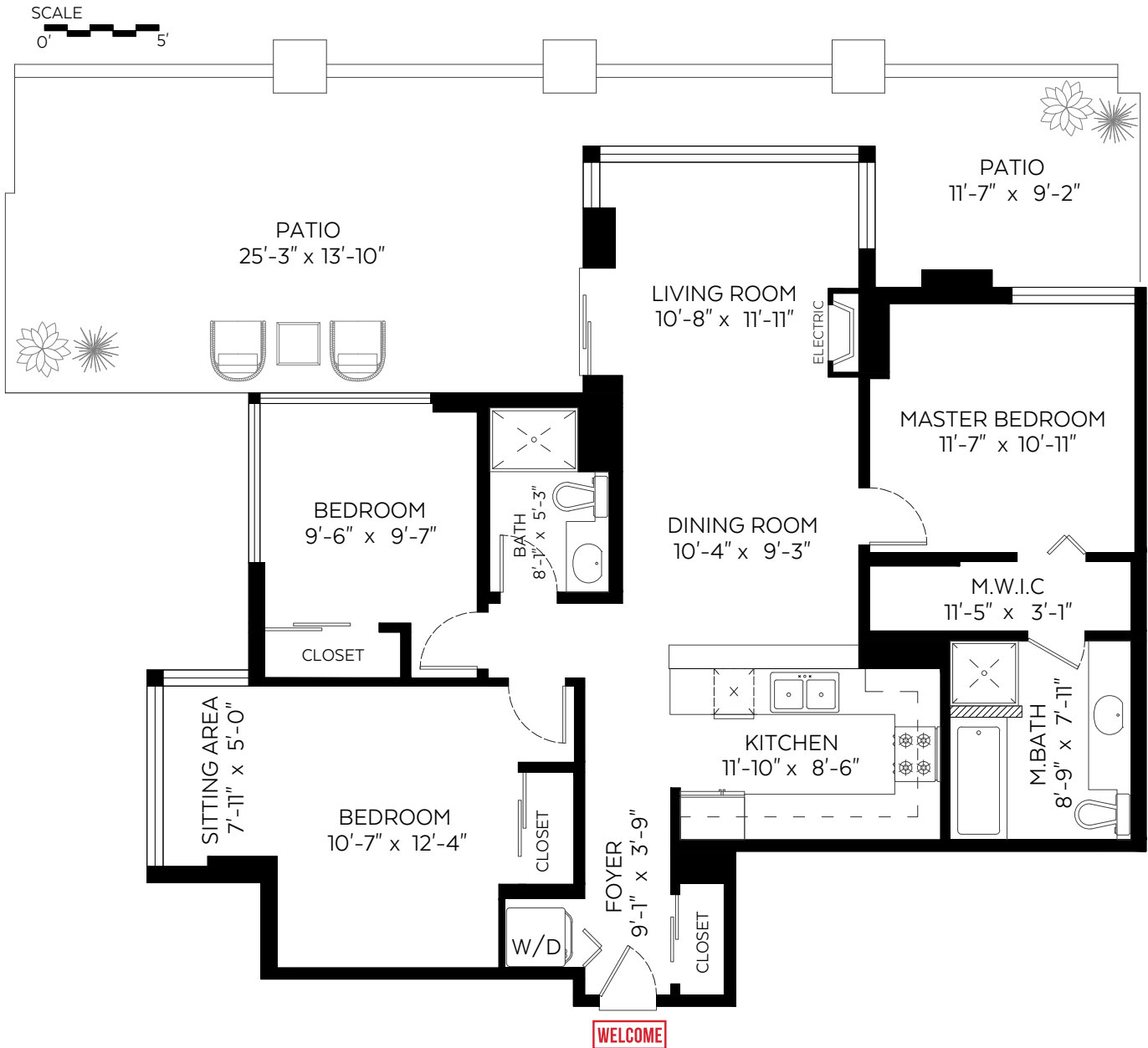

Measured on: May 8, 2019

The floor plan is not suitable for architectural/construction and is covered under E&O. © Excelsior Measuring Inc. 2019. All rights reserved for Excelsior Measuring Inc. Users shall not publish and distribute such material (in whole or in part) and/or incorporate it in other works in any form.